



SHUTTLEWORTH

DISCOVER THE COLLECTION

SUMMER TRAIL

See where the Discover Shuttleworth Chatterbox takes you. Explore the amazing exhibits in the Collection using your observation skills and curiosity.

1. Tear across the dotted line.
2. With the blank side face up fold each corner to the opposite corner, then fold each corner to the middle.
3. Turn over to the printed side and fold each corner to the middle again.
4. Turn over again and fold and unfold in half. Put thumb and index fingers into the four corner pockets and push upwards.

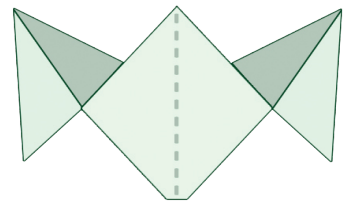
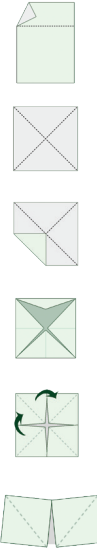

5. Get someone to pick an action from one of the corners. Pinch and push the corners as you spell the word or count to the number.

6. Lift the flap to find your challenge.

